

Layout of Gear Clutch and Gear Holder

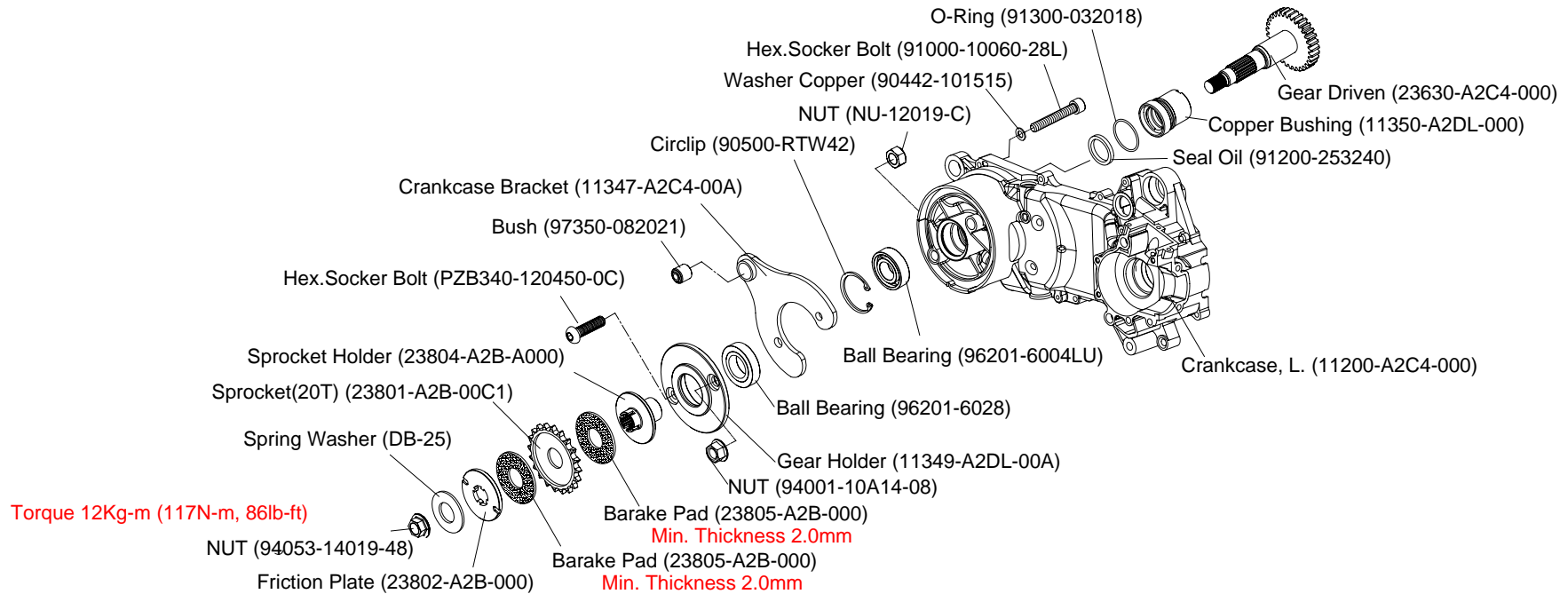

Information of Gear Clutch Installation

Step 1

Remove the original nut.



Step 2

Remove the original sprocket with chain.



Step 3

Install Sprocket Holder

Notice:

- **The raw surface must be toward to outside and don't get any grease or oil on the raw surface.**

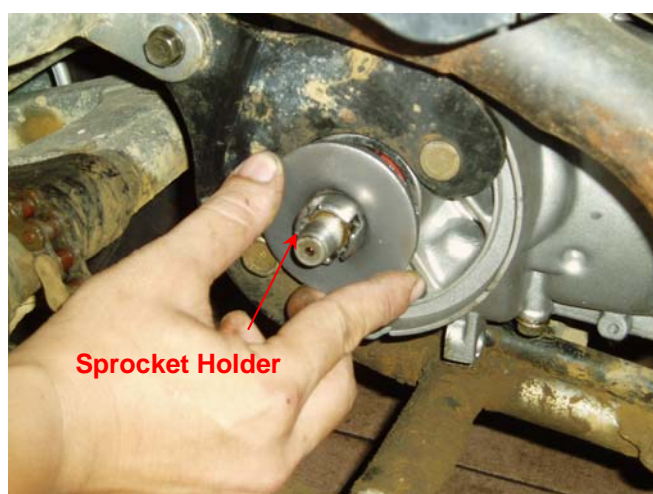

Step 4

Install Clutch Pad

Notice:

- Check the thickness, if thickness less than 2.0mm then replace.

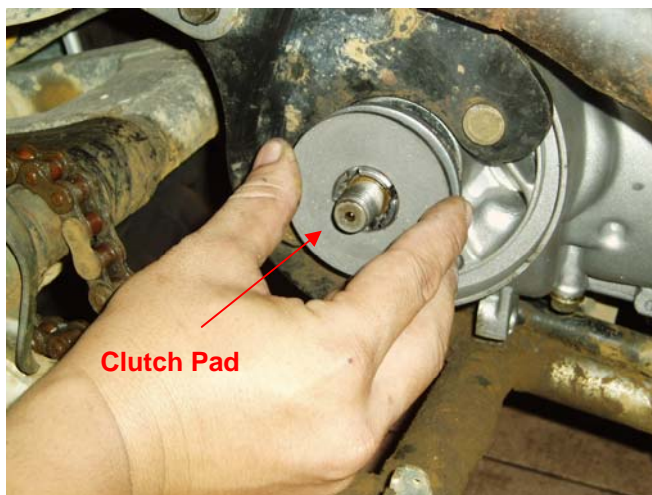

Step 5

Install Sprocket

Notice:

- The chamfer of sprocket must be toward to outside.
- Both surfaces of sprocket; don't get any grease or oil.
- If the chain is tight, loose the chain tensioner then easy to install sprocket with chain.

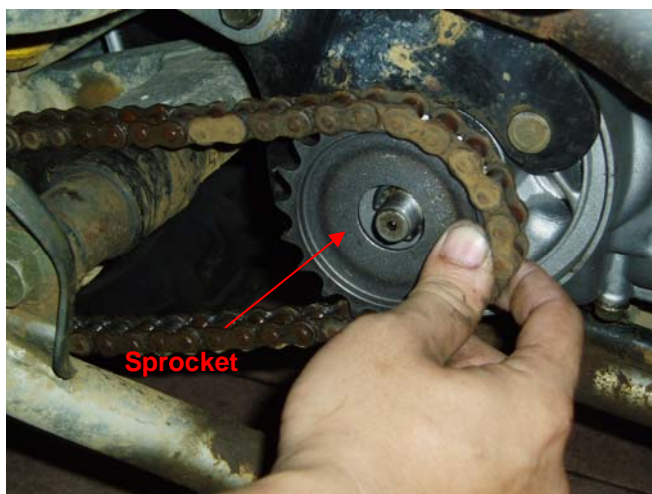

Step 6

Install Clutch Pad

Notice:

- Check the thickness, if thickness less than 2.0mm then replace.

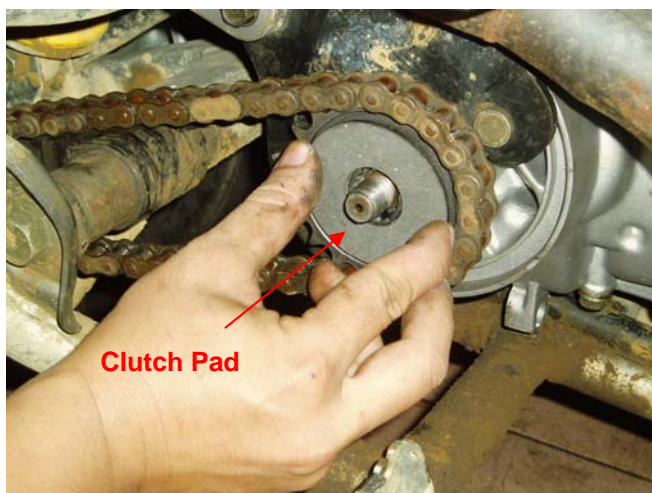

Step 7

Install Friction Plate

Notice:

- The raw surface must be toward to inside and don't get any grease or oil on the raw surface.



Step 8

Install Spring Washer

Notice:

- Check the spring washer, if the spring wear or damage then replace.



Step 9

Install Nut.

Notice:

- Install nut by tool and check the torque must be 12 kg-m (117 N-m or 86 lb-ft) in minimums.

